

## HEAT SHRINKABLE 2, 3 OR 4 LEG BOOT

### SEAL AND PROTECT MULTI-CONDUCTOR CABLE AND CONDUIT BREAKOUTS

CCB is a heat shrinkable two, three or four leg boot with a pre-coated adhesive in the legs to permanently seal the cable core, and a pre-coated adhesive in the body to seal to the cable jacket. CCB is an inexpensive method for sealing, providing mechanical protection and strain relief in the crotch area where individually jacketed wires or cores of a multi-core cable exit a common jacket.



#### PRODUCT NAME

CCB

#### PRODUCT DESCRIPTION

heat shrinkable boots seal and protect multi-conductor cable and conduit breakouts

#### APPLICATION/INSTALLATION

- Clean exposed cores
- Insert a core through each leg
- Position the cable all the way into the crotch
- Shrink in place

#### ADVANTAGE

- Boots for 2, 3 and 4 way cable breakouts
- Superior resistance to weathering, moisture, contamination and adverse environmental conditions
- Thermoplastic adhesive liner provides complete environmental protection and insulation
- Strain relief and mechanical protection
- Easy to fit over the cable
- Shrink ratio accommodates a wide range of cables

#### MARKET SEGMENT

Military, Electrical, Wire and Cable, OEM, Industrial

#### STANDARDS

ESI 09-11

#### INSTALLED 3 LEG BREAKOUT



DIMENSIONS

ORDER REFERENCE NUMBER	LEG NO	EXPANDED								RECOVERED		WALL THICKNESS OF BODY (NOM)		WALL THICKNESS OF LEG (NOM)		APPLICATION LEGS 600 V CONDUCTOR AWG/MCM
		DIAMETER (MIN)		DIAMETER (MIN)		DIAMETER (MAX)		DIAMETER (MAX)		LENGTH (NOM)		MM	IN	MM	IN	
		MM	IN	MM	IN	MM	IN	MM	IN	MM	IN	MM	IN	MM	IN	
0120	2	30.0	1.18	15.0	0.59	9.4	0.37	4.10	0.16	94.0	3.70	1.5	0.06	1.2	0.05	#10 - 2/0
0200	2	50.0	1.97	21.0	0.83	22.9	0.90	7.60	0.30	119.0	4.69	3.2	0.13	3.2	0.13	#3 - 300
0340	2	87.0	3.43	43.0	1.69	38.1	1.50	12.70	0.50	141.5	5.57	3.8	0.15	3.8	0.15	3/0 - 1000
0150	3	38.1	1.50	16.5	0.65	12.7	0.50	4.00	0.16	113.5	4.47	2.9	0.11	2.9	0.11	#8 - 3/0
0170	3	43.2	1.70	20.8	0.82	22.9	0.90	7.60	0.30	99.0	3.90	3.8	0.15	3.8	0.15	#3 - 300
0220	3	55.8	2.20	30.4	1.20	22.5	0.89	9.00	0.35	180.0	7.09	3.0	0.12	2.0	0.12	#1 - 600
0240	3	61.0	2.40	31.8	1.25	35.6	1.40	12.60	0.50	144.5	5.69	3.8	0.15	3.8	0.15	3/0 - 750
0280	3	72.0	2.83	37.0	1.46	35.0	1.38	17.50	0.69	178.0	7.01	4.0	0.16	3.0	0.12	300 - 1000
0350	3	90.0	3.54	35.0	1.38	34.0	1.34	14.00	0.55	200.0	7.87	3.0	0.12	2.0	0.08	4/0 - 1000
0430	3	110.0	4.33	40.0	1.57	35.0	1.38	17.50	0.69	178.0	7.01	4.0	0.16	3.0	0.12	300 - 1000
0490	3	125.0	4.92	50.8	2.00	59.0	2.32	25.40	1.00	283.0	11.14	3.8	0.15	3.8	0.15	750 - 1000
0140	4	35.0	1.38	15.0	0.59	12.0	0.47	3.00	0.12	132.0	5.19	3.0	0.12	2.5	0.09	#12 - 2/0
0190	4	47.4	1.87	21.5	0.85	22.9	0.90	6.40	0.25	165.1	6.50	4.1	0.16	3.3	0.13	#6 - 350
0240	4	60.0	2.36	30.0	1.18	22.9	0.90	6.40	0.25	202.0	7.95	4.1	0.16	3.3	0.13	#4 - 600
0310	4	78.7	3.10	38.1	1.50	35.6	1.40	12.50	0.49	240.0	9.45	3.3	0.13	3.3	0.13	3/0 - 1000
0520	4	133.4	5.25	34.3	1.35	76.2	3.00	14.00	0.55	254.4	10.02	4.1	0.13	4.1	0.16	4/0 - 1000

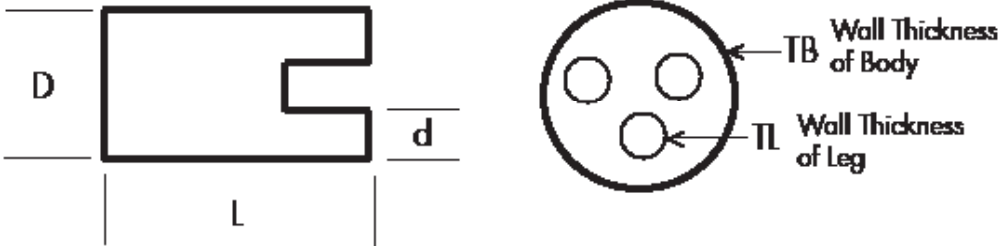

STANDARDS

- ESI 09-11

ORDERING

- Select a dimension which will shrink snugly over the component to be covered. If recovery is restricted the resultant wall thickness will be less than specified.
- Please specify the product name plus the options you require.
- Standard Product: CCB, 0120, 2 legs, black, unprinted, unlined

OPTIONS

- Printing: Printed
- Lining: Unlined

Please contact your Customer Service Representative for information on custom colours, sizes and lengths